

100% LEASED



PROPERTY DESCRIPTION

Recently built attractive strip center anchored by Walgreens, Noodles & Co. Located in the heart of Orland Park's regional shopping district directly across from the Orland Square Mall and at the entrance to the Orland Park City Hall. Great access and visibility along the busy LaGrange Road.

- **AREA TENANTS**
Macy's, Target, Lowe's, Kohl's, Sears, JC Penney
- **GLA**
23,715 SF
- **AVAILABLE SPACE**
N/A
- **TRAFFIC COUNT**
44,200 VPD along LaGrange Rd.
- **PARKING RATIO**
11.12/1,000 SF
- **SIGNAGE**
Highly visible storefront sign available

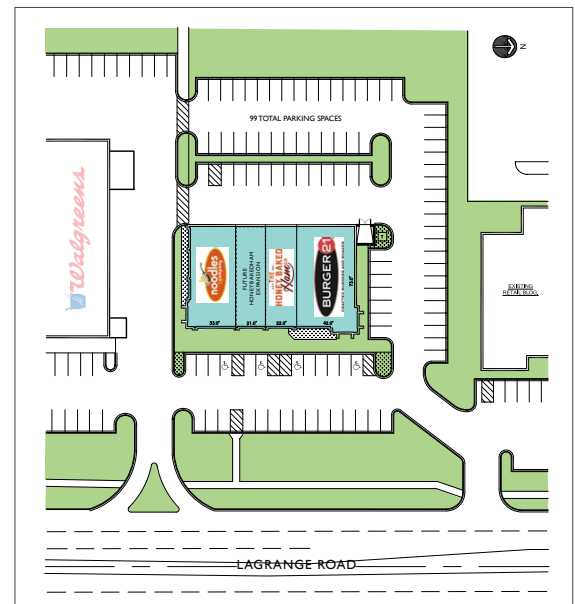

LOCATION AERIAL



DEMOGRAPHICS

	1 MILE	3 MILES	5 MILES
■ POPULATION	9,084	62,527	160,248
■ HOUSEHOLDS	3,325	21,640	54,951
■ AVG. HH INCOME	\$74,613	\$87,081	\$86,315

CONTACT INFORMATION

Joe Goodman
Director of Leasing
847-906-5023
jgoodman@terraco realestate.com

Terraco Real Estate Development & Management
3201 Old Glenview Road | Suite 300
Wilmette, Illinois 60091
www.terraco realestate.com